





■ ACCESSORIES / BULBS

ACCESSORIES



Dimensions in: mm/inch

Accessories

**Robust, watertight plug connectors –
For vertical and horizontal mounting**

Application

For inside and outside (-30°C to +130°C)

Housing

Polycarbonate black, impact and shock resistant, non-rusting, anti-magnetic, seawater resistant

Protection degree

IP 65

Mounting

With 2/4 screws \varnothing 4 mm (not included)

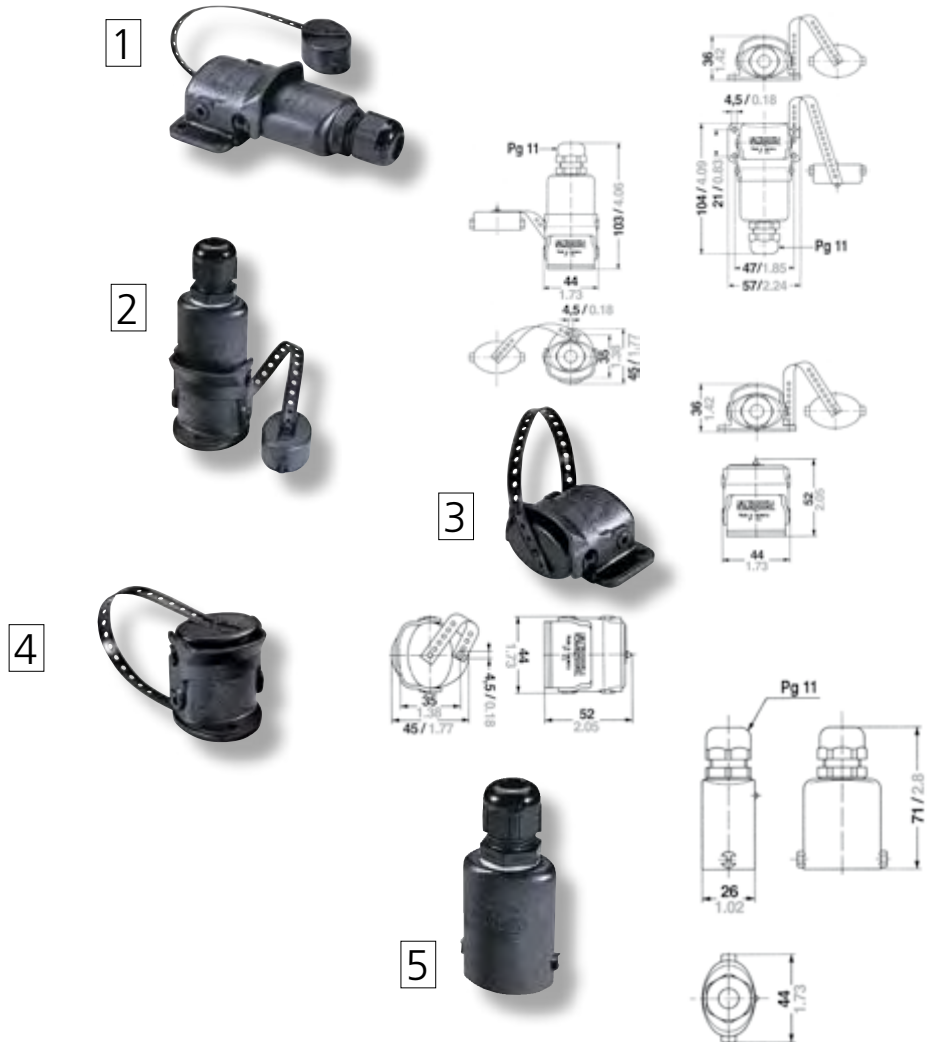

No.	Description	Housing colour	Voltage	Article number
1	Plug connection - horizontal	Black	12 V, 24 V	3928001000
2	Plug connection - vertical	Black	12 V, 24 V	3928002000
3	Power socket - horizontal	Black	12 V, 24 V	8392800100
4	Power socket - vertical	Black	12 V, 24 V	8392800200
5	Plug	Black	12 V, 24 V	8392800300

Spare Parts / Extras

	O-ring and vertical seal			8392800400
	O-ring and horizontal seal			8392800500
	Safety catch (2 pieces)			8392800600
	Cap (2 pieces)			8392800700
	Cable entry (2 pieces)			8392800800

1

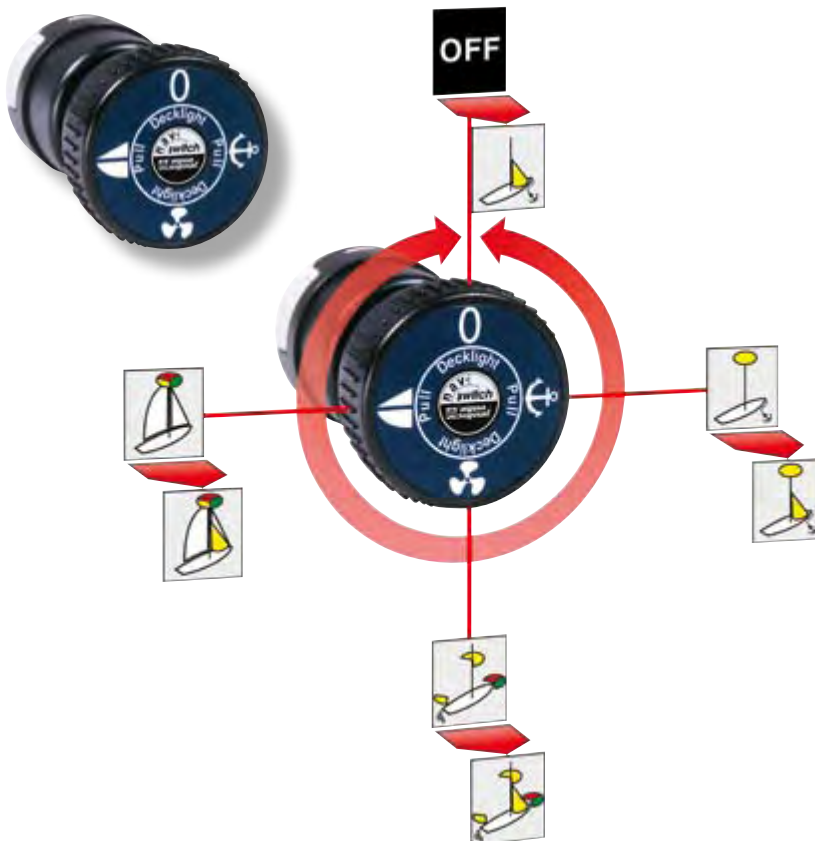

Dimensions in: mm/inch

Accessories

Nav-Switch – An ingenious multi-switch for clear and fault-free operation of navigation-, deck- and instrument lighting. An easy to install solution for safety on board

The Nav-Switch can be placed anywhere on the boat, for example on the steering station, where decisions are made. The respectively prescribed navigation lighting for moving under sail power (the sail symbol), or if the boat is under way, motor-driven (the propeller symbol) or when at anchor (the anchor symbol), can be directly altered using the switch. The instrument lighting is also switched on at the same time as the navigation lighting. A function lighting (e.g. deck illumination) can be switched on or off in every switch position by pulling on or pressing on the Nav-Switch.

Nav-Switch – There is nothing easier.

Protection degree

IP 66

No.	Description	Housing colour	Voltage	Article number
1	Nav-Switch	Black	12 V, 24 V	392850000
2	Nav-Switch	White	12 V, 24 V	On request

Data / Daten / Données / Gegevens / Dati / Datos / Dados

Electric / Elektrik / Electrique / Elettra / Parte elettrica / Sistema elettrico / Sistema eléctrico

Protection / Schutzart / Protection / Bescherming / Tipo di protezione / Protección / Protezione

Temperature / Temperatur / Température / Temperatura / Temperatura / Temperatura

Special plastic / Spezialkunststoff / Matière plastique spéciale / Speciale kunststof / Plástico especial / Plástico especial

Cable connection plan / Klemmplan / Plan des bornes / Klemmschema / Schema morsetti / Piano de bornas / Esquema de circuitos

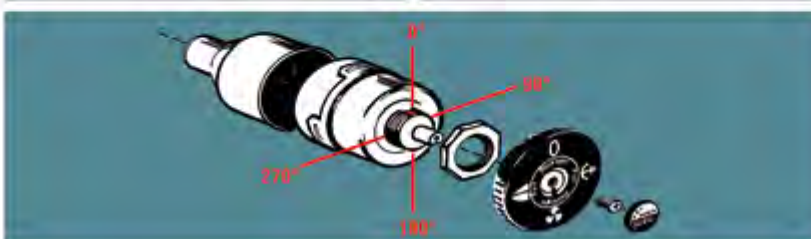

ACCESSORIES



Dimensions in: mm/inch

Accessories

Switch and fuse panels – With prewired plug connection

Housing

Aluminium, black, non-magnetic, seawater resistant. 6 switches, 6 display diodes and 23 self-adhesive stickers

Connectors

For crimp-sockets 6.3 mm

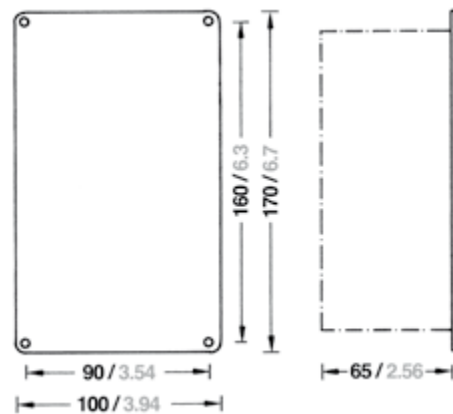

No.	Description	Housing colour	Voltage	Article number
1	Panel with 6 automatic circuit breakers 10 A	Black	12 V, 24 V	3447002000
2	Panel with 6 fuse holders for flat fuses* or automatic circuit breakers* (* Extra)	Black	12 V, 24 V	3430004000













Spare Parts / Extras				
	Self-adhesive stickers (23 pieces)			2343000300
	Replacement light diodes (6 pieces)			9010052300
	Rocker switch			9020050300
	Automatic circuit breaker 8 A			9020087500
	Automatic circuit breaker 10 A			9020087400
	Automatic circuit breaker 10 A			9020050400
	Flat fuse 2 A			9010083300
	Flat fuse 4 A			9010083400
	Flat fuse 6,3 A			9010083500
	Flat fuse 8 A			9010083600
	Flat fuse 10 A			9010083700
	Fuse holder			9020090400



BULBS

Bulbs for navigation lights

Preview	Voltage	Watts	Socket	Description	Use	Article number
	12 V	25 W	BAY 15 D	Special bulb bayonet 12 V / 25 W	Navigation lights Series 40 - 50	9040 000 200
	24 V	25 W	BAY 15 D	Special bulb bayonet 24 V / 25 W	Navigation lights Series 40 - 50	9040 000 300
	12 V	10 W	BAY 15 D	Special bulb bayonet 12 V / 10 W	Navigation lights Series 40 - 50	9040 000 500
	24 V	10 W	BAY 15 D	Special bulb bayonet 24 V / 10 W	Navigation lights Series 40 - 50	9040 000 600
	12 V / 24 V	8 W		Strobe tube 12 V / 24 V 8 W	Navigation lights Series 40 Strobe	2354 500 900
	12 V	10 W	Festoon	12 V / 10 W festoon L = 30 mm Ø 10 mm	Navigation lights Series 24	3790 022 700
	12 V	10 W	Special festoon	Special bulb festoon 12 V / 10 W	Navigation lights Series 25 (up to the middle of 2010)	9040 020 000
	24 V	10 W	Special festoon	Special bulb festoon 24 V / 10 W	Navigation lights Series 25 (up to the middle of 2010)	9040 020 100
	12 V	5 W	BA 9s	Halogen lamp 12 V / 5 W	Navigation lights Series 20	9040 038 400
	12 V	20 W	BA 9s	Halogen lamp 2 V / 20 W	Navigation lights Series 25 / Deck spotlight Sylt	9040 047 000
	12 V	100 W	R7s	Halogen rod R7s 12 V / 100 W	Deck spotlight Island	9040 048 600
	24 V	100 W	R7s	Halogen rod R7s 12 V / 100 W	Deck spotlight Island	9040 048 700
	4,8 V		PR17	SUPER BRIGHT KRYPTON	Navigation lights Series 23	9040 022 500
	4,8 V		PR17	LED insert	Navigation lights Series 23	3790 423 700
	12 V	8 W		Fluorescent tube L = 288 mm Ø 20 mm		9040 086 600
	12 V	5 W	G 4	G4 Halogen lamp 12 V / 5 W	Interior lights	9040 043 600
	12 V	10 W	G 4	G4 Halogen lamp 12 V / 10 W	Interior lights	9040 043 700

Preview	Voltage	Watts	Socket	Description	Use	Article number
	12 V	20 W	G 4	G4 Halogen lamp 12 V / 20 W	Interior lights	9040 023 400
	24 V	10 W	G 4	G4 Halogen lamp 24 V / 10 W	Interior lights	9040 056 100
	24 V	20 W	G 4	G4 Halogen lamp 24 V / 20 W	Interior lights	9040 025 300
	12 V	5 W	Festoon	SV 8,5-8 41 mm festoon 12 V / 5 W	Interior lights	9040 018 700
	12 V	10 W	Festoon	SV 8,5-8 41 mm festoon 12 V / 10 W	Interior lights / Navigation lights Series 25 (from the middle of 2010)	9040 017 700
	24 V	5 W	Festoon	SV 8,5-8 41 mm festoon 24 V / 5 W	Interior lights	9040 019 000
	24 V	10 W	Festoon	SV 8,5-8 41 mm festoon 24 V / 10 W	Interior lights / Navigation lights Series 25 (from the middle of 2010)	9040 019 100
	12 V	35 W	PAR36	Sealed Beam 12 V / 35 W	Deck spotlights	9040 030 600
	24 V	50 W	PAR36	Sealed Beam 24 V / 50 W	Deck spotlights	9040 030 800
	12 V	50 W	PAR36	Sealed Beam 12 V / 50 W Halogen	Deck spotlights	9040 030 700
	12 V	35 W	PAR36	Sealed Beam 12 V / 35 W	Searchlights	9040 017 500
	24 V	50 W	PAR36	Sealed Beam 24 V / 50 W	Searchlights	9040 020 200
	12 V	50 W	PAR36	Sealed Beam 12 V / 50 W Halogen	Searchlights	9040 022 800

Note:

The bulbs used in the navigation lights are part of the approval / certification. Reserve bulbs must also be approved.

In the case of a claim being made on an insurance policy you risk loss of your insurance cover if your equipment does not comply with regulations.

In the interest of your own safety we recommend that you only use approved material.